

**HONDA ACTIVA**

**OWNER'S MANUAL**

© Honda Motor Co., Ltd. 2009

## IMPORTANT INFORMATION

- **RIDER AND PASSENGER**

This Scooter is designed to carry the rider and one passenger.

- **ON-ROAD USE**

This scooter is designed to be used only on the road.

- **SPECIFICATIONS**

The specifications may vary with each locale.

- **READ THIS OWNER'S MANUAL CAREFULLY**

Pay special attention to the safety messages that appear throughout the manual. These messages are fully explained in the **“A Few Words About Safety”** section which appears before the Contents page.

This manual should be considered a permanent part of the scooter and should remain with the scooter when resold.

# **HONDA ACTIVA**

## **OWNER'S MANUAL**

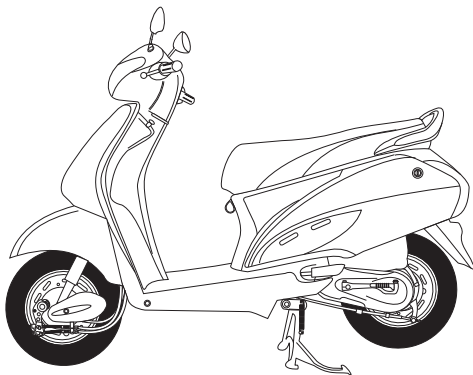

**All information in this publication is based on the latest production information available at the time of approval for printing. Honda Motor Co., Ltd. reserves the right to make changes at any time without notice and without incurring any obligation.**

**No part of this publication may be reproduced without written permission.**

## WELCOME

The scooter presents you a challenge to master the machine, a challenge to adventure. You ride through the wind, linked to the road by a vehicle that responds to your commands as no other does. Unlike an automobile, there is no metal cage around you. Like an airplane, a pre-ride inspection and regular maintenance are essential to your safety. Your reward is freedom.

To meet the challenges safely, and to enjoy the adventure fully, you should become thoroughly familiar with this owner's manual BEFORE YOU RIDE THE SCOOTER.

As you read this manual, you will find information that is preceded by a NOTICE symbol. This information is intended to help you avoid damage to your scooter, other property, or the environment.

When service is required, remember that your Honda dealer knows your scooter. If you have the required mechanical "know-how" and tools, your dealer can supply you an official Honda shop manual on paid basis to help you perform many maintenance and repair tasks.

Accessories shown in the illustration are not part of the standard equipment.

For any query or assistance, please call Customer Care No.:

**Toll Free No.: 1800 11 3434\*** (Toll free number for BSNL & MTNL users only)  
**0124-2291000**

Pleasant riding, and thank you for choosing a Honda!

## A FEW WORDS ABOUT SAFETY

Your safety, and the safety of others, is very important. And operating this scooter safely is an important responsibility.

To help you make informed decisions about safety, we have provided operating procedures and other information on labels in this manual. This information alerts you to potential hazards that could hurt you or others.

Of course, it is not practical or possible to warn you about all hazards associated with operating or maintaining a scooter. You must use your own good judgment.

You will find important safety information in a variety of forms, including:

- **Safety Labels** – on the scooter.
- **Safety Messages** – preceded by a safety alert symbol  and one of three signal words: **DANGER**, **WARNING** or **CAUTION**

These signal words mean:

## **DANGER**

You **WILL** be **KILLED** or **SERIOUSLY HURT** if you don't follow instructions.

## **WARNING**

You **CAN** be **KILLED** or **SERIOUSLY HURT** if you don't follow instructions.

## **CAUTION**

You **CAN** be **HURT** if you don't follow instructions.

- **Safety Headings** – such as Important Safety Reminders or Important Safety Precautions.
- **Safety Section** – such as scooter Safety.
- **Instructions** – how to use this scooter correctly and safely.

This entire manual is filled with important safety information—please read it carefully.

# OPERATION

page

<b>1</b>	<b>SCOOTER SAFETY</b>
1	Important Safety Information
2	Protective Apparel
5	Load Limits and Guidelines
<b>9</b>	<b>PARTS LOCATION</b>
12	Instruments and Indicators
<b>14</b>	<b>MAJOR COMPONENTS</b> <b>(Information you need to</b> <b>operate this scooter)</b>
14	Brakes
17	Fuel
19	Engine Oil
20	Tyres
<b>24</b>	<b>ESSENTIAL INDIVIDUAL</b> <b>COMPONENTS</b>
24	Ignition Switch

Page

25	Right Handlebar Controls
25	Left Handlebar Controls
<b>26</b>	<b>FEATURES</b> <b>(Not required for operation)</b>
26	Steering Lock
28	Seat Lock
28	Center Compartment
29	Document Compartment
29	Luggage Hook
29	Body Cover
30	Front Center Cover
31	Rearview Mirror
31	Headlight Case
32	Headlight Aim Vertical Adjustment

page

**32 OPERATION**

- 32 Pre-ride Inspection
- 33 Starting the Engine
- 36 Running-in
- 36 Riding
- 40 Parking
- 41 Anti-theft Tips

**MAINTENANCE**

**43 MAINTENANCE**

- 43 The Importance of Maintenance
- 43 Maintenance Safety
- 44 Safety Precautions
- 45 Tool Kit
- 46 Maintenance Schedule
- 49 Serial Numbers
- 50 Colour Label
- 50 Air Cleaner
- 51 Secondary Air Supply System

page

- 52 Crankcase Breather
- 53 Engine Oil
- 55 Engine Oil Strainer Screen
- 56 Spark Plug
- 58 Engine Idle RPM
- 58 Wheel Removal
- 61 Brake Shoe Wear
- 62 Battery
- 64 Fuse Replacement
- 66 Bulb Replacement

**68 CLEANING**

**71 STORAGE GUIDE**

- 71 Storage
- 72 Removal from Storage

**73 SPECIFICATIONS**

**76 CATALYTIC CONVERTER**



## **SCOOTER SAFETY**

### **IMPORTANT SAFETY INFORMATION**

Your scooter can provide many years of service and pleasure – if you take responsibility for your own safety and understand the challenges that you can meet on the road.

There is much that you can do to protect yourself when you ride. You'll find many helpful recommendations throughout this manual. Following are a few that we consider most important.

#### **Always Wear a Helmet**

It's a proven fact: Helmets significantly reduce the number and severity of head injuries. So always wear a helmet and make sure your passenger does the same. We also recommend that you wear eye protection, sturdy boots, gloves and other protective gear (page 3).

#### **Make Yourself Easy to see**

Some drivers do not see scooters because they are not looking for them. To make yourself more visible, wear bright reflective clothing, position yourself so other drivers can see you, signal before turning or changing lanes, and use your horn when required, it will help others notice you.

#### **Don't Drink and Ride**

Alcohol and riding don't mix. Even one drink can reduce your ability to respond to changing conditions, and your reaction time gets worse with every additional drink. So don't drink and ride, and don't let your friends drink and ride either.

## **Ride Within Your Limits**

Pushing the limits is another major cause of scooter accidents. Never ride beyond your personal abilities or faster than conditions warrant. Remember that alcohol, drugs, fatigue and inattention can significantly reduce your ability to make good judgements and ride safely.

## **Keep Your Vehicle in Safe Condition**

For safe riding, it is important to inspect your scooter before every ride and perform all recommended maintenance. Never exceed load limits, and only use accessories that have been approved by Honda for this scooter. See page 5 for more details.

## **PROTECTIVE APPAREL**

For your safety, we strongly recommend that you always wear an approved scooter helmet, eye protection, boots, gloves, long pants and a long-sleeved shirt or jacket whenever you ride. Although complete protection is not possible, wearing proper gear can reduce the chance of injury when you ride.

Following are suggestions to help you choose proper gear.

### **WARNING**

Not wearing a helmet increases the chance of serious injury or death in a crash.

Be sure you and your passenger always wear a helmet, eye protection and other protective apparel when you ride.

## **Helmets and Eye Protection**

Your helmet is your most important piece of riding gear because it offers the best protection against head injuries. A helmet should fit your head comfortably and securely. A bright-colored helmet can make you more noticeable in traffic, as can reflective strips.

An open-face helmet offers some protection, but a full-face helmet offers more. Always wear a face shield or goggles to protect your eyes and help your vision.

## **Additional Riding Gear**

In addition to a helmet and eye protection, we also recommend:

- Sturdy boots with non-slip soles to help protect your feet and ankles.
- Leather gloves to keep your hands warm and help prevent blisters, cuts, burns and bruises.
- A scooter riding suit or jacket for comfort as well as protection. Bright-colored and reflective clothing can help make you more noticeable in traffic. Be sure to avoid loose clothes that could get caught on any part of your scooter.

ALWAYS wear a helmet

You should also wear a face shield or goggles

हमेशा हेल्मेट पहनें।

चश्में अथवा चेहरे को ढकने वाले कवच का प्रयोग करना चाहिये।

Clothes should be close fitting

शरीर के फिटिंग के कपड़े ही पहनें।

Wear gloves

दस्ताने पहनें।

Wear bright or reflective clothing

चमकदार तथा रोशनी को प्रतिबिम्बित करने वाले  
कपड़े पहनें।

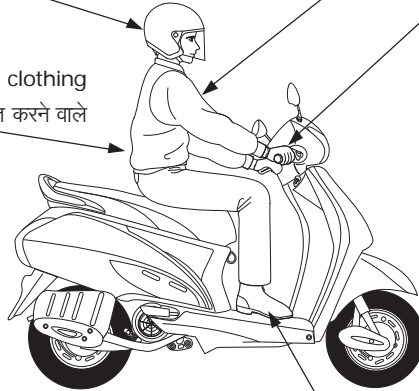

Shoes should be close-fitting, have low heels and offer ankle protection

सही नाप, कम हील तथा टखनों को सुरक्षा देने वाले जूते पहनें।

## LOAD LIMITS AND GUIDELINES

Your scooter has been designed to carry you, one passenger and a limited amount of cargo. When you add cargo or carry a passenger, you may feel some difference during acceleration and braking. But so long as you keep your scooter well-maintained, with good tyres and brakes, you can safely carry loads within the given limits and guidelines.

However, exceeding the weight limit or carrying an unbalanced load can seriously affect your scooter's handling, braking and stability. Non-Honda accessories, improper modifications, and poor maintenance can also reduce your safety margin.

The following pages give more specific information on loading, accessories and modifications.

## Loading

How much weight you put on your scooter, and how you load it, are important to your safety. Anytime you ride with a passenger or cargo you should be aware of the following information.

### **WARNING**

Overloading or improper loading can cause a crash and you can be seriously hurt or killed.

Follow all load limits and other loading guidelines in this owner's manual.

## Load Limits

Following are the load limits for your scooter:

### Maximum weight capacity:

170 kg (375 lbs)

Includes the weight of the rider, passenger, all cargo and all accessories.

The weight of added accessories will reduce the maximum cargo weight you can carry.

Putting too much weight in individual storage compartments can also affect stability and handling. So be sure to stay within the limits given below:

### Maximum weight:

<b>in center compartment</b>	10 kg (22 lbs)
<b>luggage hook</b>	1.5 kg (3.3 lbs)

Center compartment weight limit

(मध्य कक्ष की भार सीमा)

10 kg (22 lbs)

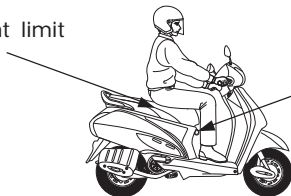

Luggage hook weight limit

(लगेज हुक की भार सीमा)

1.5 kg (3.3 lbs)

## Loading Guidelines

Your scooter is primarily intended for transporting you and a passenger.

If you wish to carry more cargo, check with your Honda dealer for advice, and be sure to read the information regarding accessories on page 7.

Improperly loading your scooter can affect its stability and handling. Even if your scooter is properly loaded, you should ride at reduced speeds whenever carrying cargo.

Follow these guidelines whenever you carry a passenger or cargo:

- Check that both tyres are properly inflated.
- To prevent loose items from creating a hazard, make sure the center compartment is closed and that any other cargo is securely tied down before you ride away.

- Place cargo weight as close to the center of the scooter as possible.
- Balance cargo weight evenly on both sides.

## Accessories and Modifications

Modifying your scooter or using non-Honda accessories can make your scooter unsafe. Before you consider making any modifications or adding an accessory, be sure to read the following information.

### **WARNING**

Improper accessories or modifications can cause a crash in which you can be seriously hurt or killed.

Follow all instructions in this owner's manual regarding accessories and modifications.

## Accessories

We strongly recommend that you use only genuine Honda accessories that have been specifically designed and tested for your scooter. Because Honda cannot test all other accessories, you must be personally responsible for proper selection, installation and use of non-Honda accessories. Check with your dealer for assistance and always follow these guidelines:

- Make sure the accessory does not obscure any lights, reduce ground clearance and banking angle, limit suspension travel or steering travel, alter your riding position or interfere with operating any controls.
- Be sure electrical equipment does not exceed the scooter's electrical system capacity (page 75). A blown fuse can cause a loss of lights or engine power.

- Do not pull a trailer or sidecar with your scooter. This scooter is not designed for these attachments, and their use can seriously impair your scooter's handling.

## Modifications

We strongly advise you not to remove any original equipment or modify your scooter in any way that would change its design or operation. Such changes could seriously impair your scooter's handling, stability and braking, making it unsafe to ride.

Removing or modifying your lights, mufflers, emission control system or other equipment can also make your scooter illegal.



## PARTS LOCATION

Rear brake (Activa Standard)/  
combi brake (Activa Deluxe)  
lever

रियर ब्रेक (एक्टिवा स्टैन्डर्ड) / कॉम्बी ब्रेक  
(एक्टिवा डीलक्स) लीवर

Brake lock lever

ब्रेक लॉक लीवर

Headlight dimmer  
switch

हैडलाइट डिमर स्विच

Horn switch

हॉर्न स्विच

Turn signal switch

टर्न सिगनल स्विच

Choke knob

चोक नॉब

Rearview mirror

रियर व्यू मिरर

Indicator

इंडिकेटर

Speedometer

स्पीडोमीटर

Fuel gauge

फ्यूल गेज

Rearview mirror

रियर व्यू मिरर

Front Brake Lever

फ्रंट ब्रेक लीवर

Throttle grip

थ्रॉटल ग्रिप

Headlight switch

हैडलाइट स्विच

Starter switch

स्टार्टर स्विच

Ignition switch

इग्निशन स्विच

Ignition switch shutter (Activa Deluxe)

इग्निशन स्विच शटर (एक्टिवा डीलक्स)

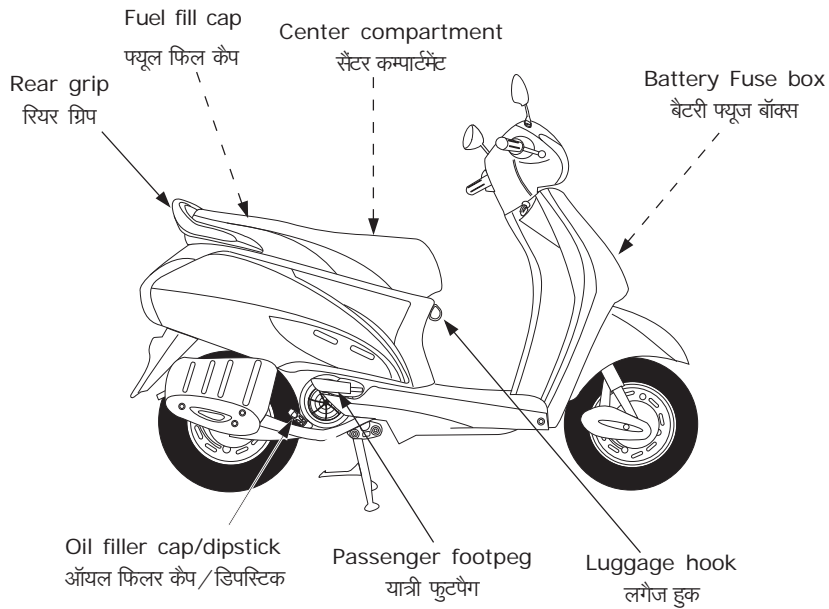

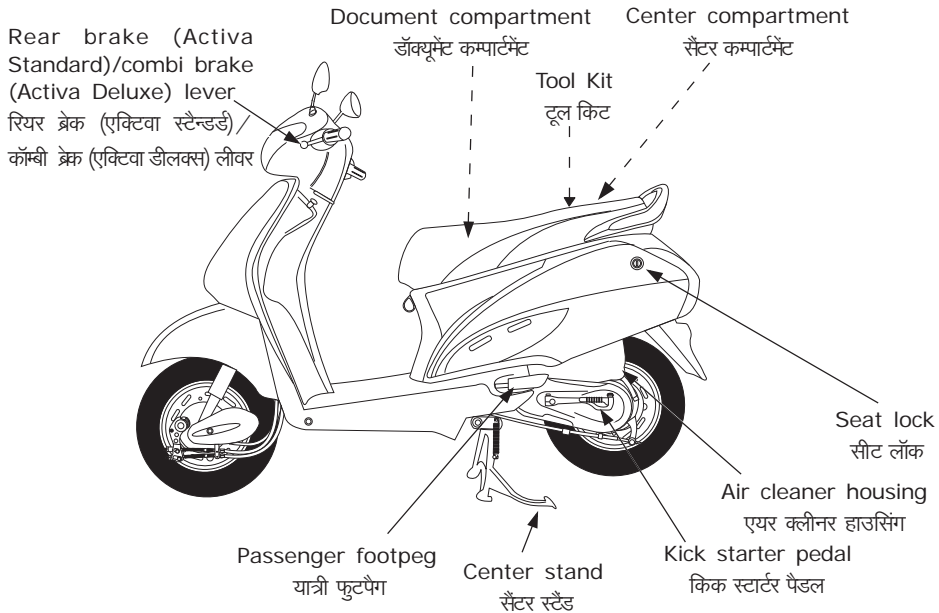

## INSTRUMENTS AND INDICATORS

The indicators are contained in the instrument panel. Their functions are described in the tables on the following pages.

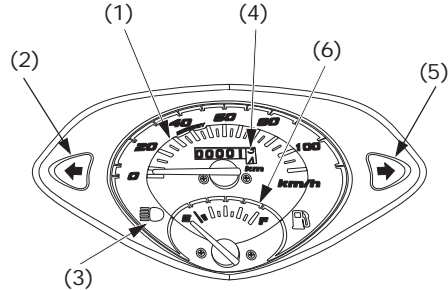

- (1) Speedometer (स्पीडोमीटर)
- (2) Left turn signal indicator (बायां टर्न सिगनल इंडिकेटर)
- (3) High beam indicator (हाई बीम इंडिकेटर)
- (4) Odometer (ऑडोमीटर)
- (5) Right turn signal indicator (दायां टर्न सिगनल इंडिकेटर)
- (6) Fuel gauge (फ्यूल गेज)

(Ref. No.) Description	Function
(1) Speedometer	Shows riding speed.
(2) Left turn signal indicator (green)	Flashes when the left turn signal operates.
(3) High beam indicator (blue)	Lights when the headlight is glowing on high beam.
(4) Odometer	Shows accumulated mileage.
(5) Right turn signal indicator (green)	Flashes when the right turn signal operates.
(6) Fuel gauge	Shows approximate fuel quantity available. (Ref. page 14)

## Fuel Gauge (1)

When the gauge needle enters the red band (2), fuel will be low and you should refill the tank as soon as possible. The amount of fuel left in the tank when the needle enters the red band is approximately:

1.4 Ltr. (0.36 gal, 0.30 UK gal)

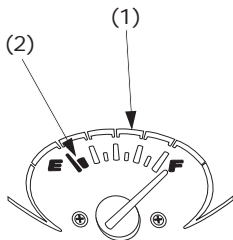

(1) Fuel gauge (फ्यूल गेज)

(2) Red band (लाल बैंड)

## MAJOR COMPONENTS

### (INFORMATION YOU NEED TO OPERATE THIS SCOOTER)

#### BRAKES

Brakes are items of personal safety and should always be maintained with proper adjustment.

##### Incase of Activa (Standard)

When one applies the left lever, only rear brake activates.

##### Incase of Activa (Deluxe)

Whereas on application of left lever, front & rear brake activates jointly.

#### Free play

The free effortless movement of brake levers untill the brakes start activate is termed as free play.

Measured at the tip of the brake levers, freeplay should be maintained at:  
10 - 20 mm (0.4 - 0.8 in)

### Incase of Activa (Standard)

Freeplay: 10-20 mm (3/8-3/4 in)

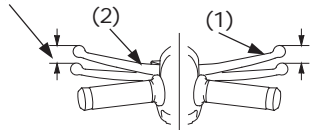

### Incase of Activa (Deluxe)

Freeplay: 10-20 mm (3/8-3/4 in)

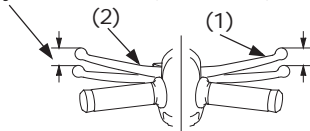

- (1) Front brake lever (फ्रंट ब्रेक लीवर)
- (2) Rear brake (Activa Standard)/  
combi brake (Activa Deluxe) lever  
रियर ब्रेक (एक्टिवा स्टैन्डर्ड)/ कॉम्बी ब्रेक (एक्टिवा डीलक्स) लीवर

### Adjustment:

#### Incase of Activa (Standard)

1. Make freeplay adjustments by turning the adjusting nut (2) at the brake arm (1).

### Incase of Activa (Deluxe)

Adjustment of right hand front brake cable (8) no 1 side. Push the brake arm by hand (Push direction →). Turn 1st adjuster nut (2a) till you can not turn it by hand.

### NOTICE

1 & 2 is marked on brake arm.

Check the free play of right lever.

### FREE PLAY: 10-20 mm (3/8-3/4 in)

Adjustment of left hand front brake cable (7) no 2 side. Push the brake arm by hand (Push direction →).

Turn 2nd adjuster nut (2b) untill the clearance is caused in joint (4) and a slot of the 1st side in brake arm.

The half rotation returns the 2nd adjuster nut (2b).

## Incase of Activa (Standard)

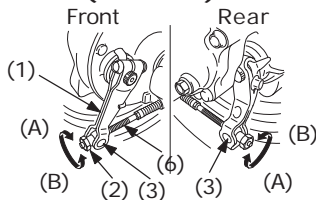

## Incase of Activa (Deluxe)

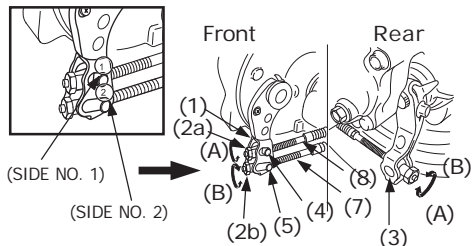

- (1) Brake Arm (ब्रेक आर्म्) (2) Adjusting nut (एडजस्टिंग नट)  
 (3) Joint Pin (ज्वाइट पिन)  
 (4) Joint Pin side no 1 (ज्वाइट पिन साईड नम्बर 1)

- (5) Joint Pin side no 2 (ज्वाइट पिन साईड नम्बर 2)  
 (6) Brake cable (ब्रेक केबल)  
 (7) Left hand front brake cable (बांये हाथ के तरफ की ब्रेक केबल)  
 (8) Right hand front brake cable (दांये हाथ के तरफ की ब्रेक केबल)  
 (A) Decrease freeplay (फ्री प्ले घटाये)  
 (B) Increase freeplay (फ्री प्ले बढ़ाये)

2. Apply the brake several times and check for free wheel rotation after the brake lever is released.

If proper adjustment cannot be obtained by this method, see your Honda dealer.

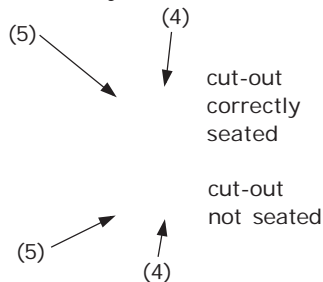



## Other Checks

Check the brake cable for kinks or signs of wear that could cause sticking or failure.

Lubricate the brake cable with a commercially available cable lubricant to prevent premature wear and corrosion.

Make sure the brake arm, spring and fasteners are in good condition.

## FUEL

### Fuel Tank

The fuel tank is located under the seat.

The fuel tank capacity including the reserve supply is:

5.3 Ltr. (1.4 US gal, 1.17 Imp gal)

To open the fuel fill cap (1), unlock and lift up the seat (Ref. page 28), then remove the fuel fill cap by turning it counterclockwise.

Do not overfill the tank. There should be no fuel in the filler neck (2).

After refueling, be sure to tighten the fuel fill cap firmly by turning it clockwise.

Make sure that the arrow marks (3) on the fuel fill cap and fuel tank is aligned.

## ⚠ WARNING

Petrol is highly flammable and explosive. You can be burned or seriously injured when handling fuel.

- Stop the engine and keep heat, sparks and flame away.
- Refuel only outdoors.
- Wipe out spills immediately.

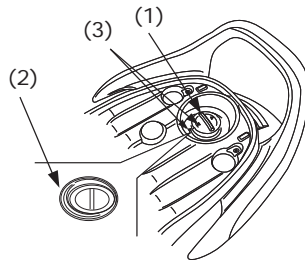

(1) Fuel fill cap (फ्यूल फिल कैप)

(2) Filler neck (फिलर नैक)

(3) Arrow marks (ऐरो मार्क्स)

Use unleaded petrol with a research octane number of 87 or higher.

The use of leaded petrol will cause premature damage to the catalytic converter.

### **NOTICE**

If “spark knock” or “pinking” occurs at a steady engine speed under normal load, change brands of petrol. If spark knock or pinking persists, consult your Honda dealer. Failure to do so is considered misuse, and damage caused by misuse is not covered by Honda’s Limited Warranty.

### **Petrol Containing Alcohol**

If you decide to use a petrol containing alcohol (gasohol), be sure it’s octane rating is at least as high as that recommended by Honda.

- When certain types of petrol containing alcohol are used, problems such as hard starting, poor performance, etc. may occur.
- If you notice any undesirable operating symptoms while using a petrol that contains alcohol, or one that you think contains alcohol, try another station or switch to another brand of petrol.
- When a problem resulting from the use of petrol containing alcohol occurs, contact your Honda dealer.
- Use of fuel containing higher than the recommended limit is considered misuse and damage caused by misuse is not covered by Honda’s Limited Warranty.

## ENGINE OIL

### Engine Oil level Check

Check the engine oil level each day before riding the scooter.

The level must be maintained between the upper (1) and lower (2) level marks on the oil filler cap/dipstick (3).

1. Start the engine and let it idle for 3 – 5 minutes.
2. Stop the engine and put the scooter on its center stand on level ground.
3. After 2–3 minutes, remove the oil filler cap/dipstick, wipe it clean, and reinsert the oil filler cap/dipstick without screwing it in. Remove the oil filler cap/dipstick. The oil level should be between the upper and lower marks on the oil filler cap/dipstick.

4. If required, add the specified oil (Ref. page 53) up to the upper level mark. Do not overfill.
5. Reinstall the oil filler cap/ dipstick. Check for oil leaks.

### NOTICE

Running the engine with insufficient oil pressure may cause serious engine damage. If engine oil level is below from 'Min.' mark, please contact Honda Authorised Dealer.

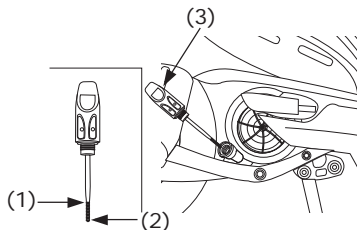

- (1) Upper level mark (ऊपरी स्तर चिन्ह)
- (2) Lower level mark (निचला स्तर चिन्ह)
- (3) Oil filler cap/dipstick (ऑयल फिलरकैप/डिपस्टिक)

## TYRES

To safely operate your scooter, your tyres must be the proper type and size, in good condition with adequate tread, and correctly inflated for the load you are carrying. The following pages give more detailed information on how and when to check your air pressure, how to inspect your tyres for damage, and what to do when your tyres need to be repaired or replaced.

### **WARNING**

Using tyres that are excessively worn or improperly inflated can cause a crash in which you can be seriously hurt or killed.

Follow all instructions in this owner's manual regarding tyre inflation and maintenance.

## Air Pressure

Keeping your tyres properly inflated provides the best combination of handling, tread life and riding comfort. Generally, underinflated tyres wear unevenly, adversely affect handling, and are more likely to fail from being overheated.

Overinflated tyres make your scooter ride more harsh, are more prone to damage from road hazards and wear unevenly.

We recommend that you visually check your tyres before every ride and use a gauge to measure air pressure at least once a month or any time you think the tyres air pressure might be low.

Always check air pressure when tyres are "cold"—when the scooter has been parked for at least three hours. If you check air pressure when tyres are "warm"—When the scooter has been ridden for even a few miles the readings will be higher than if the tyres were "cold". This is normal so do not let air

out of the tyres to match the recommended cold air pressures given below. If you do, the tyres will be underinflated.

The recommended “Cold” tyre air pressures are:

kPa (kgf/cm <sup>2</sup> , psi)		
Driver only	Front	150 (1.50, 22)
	Rear	200 (2.00, 29)
Driver and one passenger	Front	150 (1.50, 22)
	Rear	250 (2.50, 36)

This scooter is fitted with TUFFUP tube only in rear wheel. Compared with ordinary tyre tubes, the TUFFUP tube releases little air when punctured by a nail or other similar object. For this reason even though they remain fully inflated, it is important to regularly check the tyres for embedded objects.

The TUFFUP tube is not intended to prevent tyre puncture completely. It is not effective in damage or L-shaped cut in the tread surface, or damage or cut in the tyre other than the tread surface.

## Inspection

Whenever you check the tyre pressures, you should also examine the tyre treads and sidewalls for wear, damage, and foreign objects:

Look for:

- Bumps or bulges in the side of the tyre or the tread. Replace the tyre if you find any bumps or bulges.
- Cuts, splits or cracks in the tyre. Replace the tyre if you can see fabric or cord.
- Excessive tread wear.

Also, if you hit a pothole or hard object, pull to the side of the road as soon as you safely can and carefully inspect the tyres for damage.

### Tread Wear

Inspect the wear indicator (1) to check for insufficient tread depth. If the wear indicator is visible, the tyre should be replaced.

#### Incase of Activa (Standard)

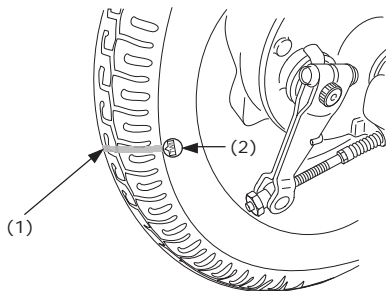

#### Incase of Activa (Deluxe)

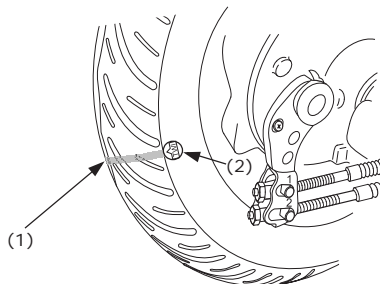

(1) Wear indicator (वीयर इन्डिकेटर)

(2) Wear indicator location mark  
(वीयर इन्डिकेटर का लोकेशन मार्क)

### Tube Repair and Replacement

If a tube is punctured or damaged, you should replace it as soon as possible. A tube that is repaired may not have the same reliability as a new one, and it may fail while you are riding.

If you need to make a temporary repair by patching a tube or using an aerosol sealant, ride cautiously at reduced speed and have the tube replaced before you ride again. Any time a tube is replaced, the tyre should be carefully inspected as described on page 22.

When replacing a TUFFUP tube, be sure to select the size appropriate for the tyre. Because of the special construction of the TUFFUP tube, it should always be repaired or replaced by your Honda dealer.

### **Tyre Replacement**

The tyres that came on your scooter were designed to match the performance capabilities of your scooter and provide the best combination of handling, braking, durability and comfort.

### **⚠ WARNING**

Installing improper tyres on your scooter can affect handling and stability. This can cause a crash in which you can be seriously hurt or killed.

Always use the size and type of tyres recommended in this owner's manual.

The recommended tyres for your scooter are:

### **Incase of Activa (Standard)**

Front : 90/100-10 53J

Rear: 90/100-10 53J

### **Incase of Activa (Deluxe)**

Front : 90/100-10 53J - Zapper

Rear: 90/100-10 53J - Zapper

Whenever you replace a tyre, use one that is equivalent to the original and be sure the wheel is balanced after the new tyre is installed.

Also remember to replace the inner tube whenever you replace a tyre. The old tube will probably be stretched, and if installed in a new tyre, it could fail.

## ESSENTIAL INDIVIDUAL COMPONENTS

### IGNITION SWITCH

The ignition switch (1) is on the right side below the steering stem.

#### Incase of Activa (Standard)

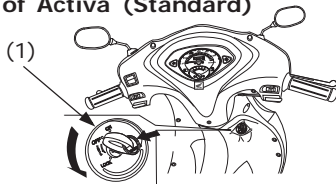

#### Incase of Activa (Deluxe)

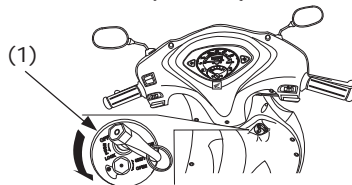

(1) Ignition switch (इग्नीशन स्विच)

Key Position	Function	Key Removal
LOCK (steering lock)	Steering is Locked. Engine and lights can not be operated.	Key can be removed
OFF	Engine and lights cannot be operated.	Key can be removed
ON	Engine and lights can be operated	Key cannot be removed



## RIGHT HANDLEBAR CONTROLS

### Headlight Switch

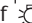
The headlight switch (1) has two positions;  and OFF marked by a dot to the right of .

: Headlight, taillight and meter lights on.

OFF (dot) : Headlight, taillight and meter lights off.

The headlight, taillight and meter lights operates only when the engine is running.

### Starter Button

The starter button (2) is below the headlight switch.

When the starter button is pressed, the starter motor cranks the engine. (Ref. page 33 for the starting procedure.)

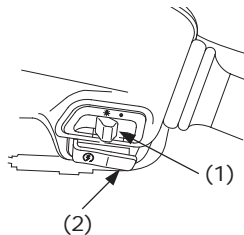



(1) Headlight switch (हैडलाइट स्विच)



(2) Starter button (स्टार्टर बटन)

## LEFT HANDLEBAR CONTROLS

### Headlight Dimmer Switch (1)

Push the dimmer switch to  (HI) to select high beam or to  (LO) to select low beam.

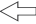
### Turn Signal Switch (2)

Move to  (L) to signal a left turn,  (R) to signal a right turn. Press to turn signal off.

## Horn Button (3)

Press the button to sound the horn.

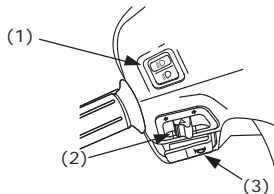

(1) Headlight dimmer switch (हैडलाइट डिमर स्विच)

(2) Turn signal switch (टर्न सिग्नल स्विच)

(3) Horn button (हॉर्न बटन)

## FEATURES

(NOT required for operation)

### STEERING LOCK

**Incase of Activa (Standard/Deluxe)**

Move the handle towards left to lock the steering, Slightly push the key (1) and turn it anticlockwise direction. Remove the key.

### Incase of Activa (Deluxe)

In addition to the standard model process. Close the key shutter by turning the shutter pin anticlockwise.

### STEERING UNLOCK

**Incase of Activa (Standard)**

To unlock the steering, insert the key and turn the key to OFF.

**Incase of Activa (Deluxe)**

#### Step 1:-

To unlock the steering, open the key shutter by aligning & inserting the hexagonal shape key into the key shutter and rotate it clockwise.

#### Step 2:-

Insert the key and turn the key to OFF. Do not turn the key to LOCK while riding the scooter, loss of vehicle control will result.

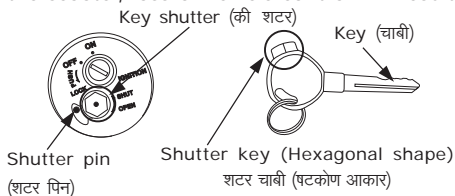

## LOCKING

Incase of Activa (Standard)

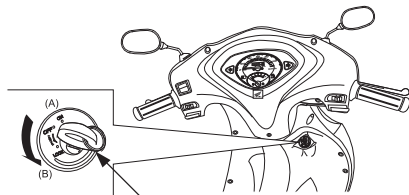

(1)

Incase of Activa (Deluxe)

## UNLOCKING

Incase of Activa (Standard)

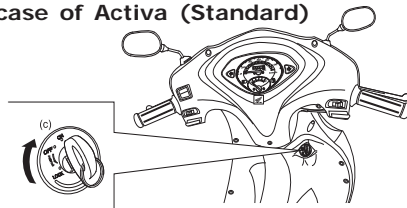

Incase of Activa (Deluxe)

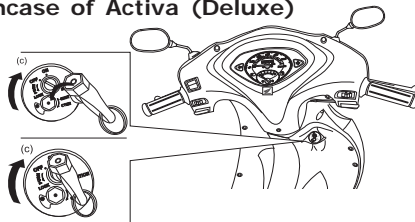

(1) Ignition Key (इग्निशन चाबी)

(A) Push in (चाबी को दबायें)

(B) Turn to LOCK (लॉक की ओर घुमाइये)

(C) Turn to OFF (ऑफ की ओर घुमाइये)

## SEAT LOCK

The seat lock (1), is on the left side below the seat.

To lift the seat, insert the ignition key (2) and turn it clockwise to unlock.

To lock the seat, lower and push down on it until it locks. Make sure the seat is secure before riding.

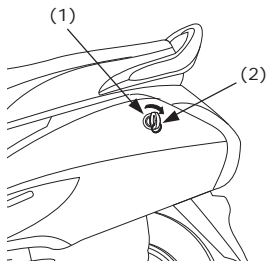

(1) Seat lock (सीट लॉक)

(2) Ignition Key (इग्नीशन की चाँबी)

## CENTER COMPARTMENT

The center compartment (1) is below the seat. For opening and closing:

See "SEAT LOCK" (Ref. page 28)

**MAXIMUM WEIGHT LIMIT : 10 KG (22 IBS)**

Never exceed the maximum weight limit, handling and stability may be severely affected.

The center compartment may become heated by the engine. Do not store food and other articles which are flammable or susceptible to heat damage in this compartment

Do not direct water under pressure against the center compartment as water will be forced in to the compartment.

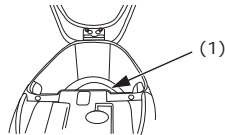

(1) Center Compartment (सैंटर कम्पार्टमेंट)

## DOCUMENT COMPARTMENT

The document compartment (1) is located on the reverse side of the seat.

Owner's manual and other documents should be stored in this compartment.

When washing your scooter, be careful not to flood this area with water.

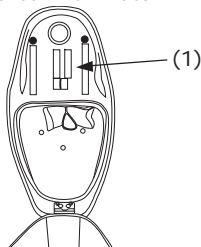

(1) Document Compartment (दस्तावेज कक्ष)

## LUGGAGE HOOK

The luggage hook (1) provided below the seat.

## MAXIMUM WEIGHT LIMIT:

1.5 kg (3 lbs)

Do not attach large luggage to the hook that would hang out from the scooter and/or interfere with the movement of your feet and handle operation.

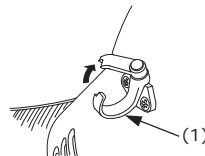

(1) Luggage hook (लगेज हुक)

## BODY COVER

### Raise:

1. Open the seat (Ref. page 28).
2. Remove the bolt A (1) and bolts (B) (2).
3. Lift up the body cover (3) and stand the rod (4).

## Installation:

- Installation can be done in the reverse order of removal.

Do not move the scooter by holding it by the rear grip when the body cover lifted up. Do not sit on the seat when the body cover lifted up.

Place the scooter on its center stand when servicing the scooter with the body cover lifted up.

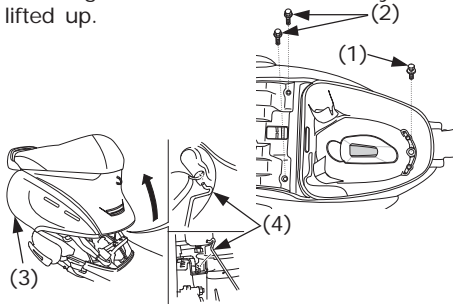

- (1) Bolt A (बोल्ट A)      (2) Bolt B (बोल्ट B)  
(3) Body cover (बॉडी कवर) (4) Rod (रॉड)

## FRONT CENTER COVER

Removal :

1. Remove the screws - 4 nos. (1).
2. Release the boss from mounting grommet - 4 nos. (2).
3. Remove the front center cover (3).

Installation :

- Installation can be done in the reverse order of removal.

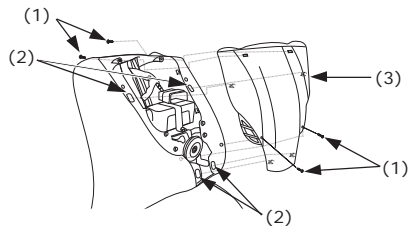

- (1) Screws (स्क़ूज़)  
(2) Mounting Grommet (माउंटिंग ग्रोमिट)  
(3) Front center cover (फ्रंट सेंटर कवर)

## REARVIEW MIRROR

Removal :

1. Pull the dust cover (1).
2. Loosen the lock nut (2) until it will no longer turn.
3. Loosen the rearview mirror (3), (4) and remove it.

Installation :

1. Install the rearview mirror (3) clockwise, mirror (4) anticlockwise until it will no longer turn.
2. Loosen the rearview mirror approximately 2 turns.
3. Adjust the rearview mirror.
4. Tighten the lock nut.

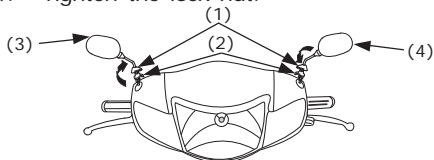

- (1) Dust cover (डस्ट कवर) (2) Lock nut (लॉक नट)  
(3) & (4) Rearview mirror (रियर व्यू मिरर)

## HEADLIGHT CASE

Removal :

1. Remove the rearview mirror (Ref. page 31).
2. Remove the screw A (1) and screws B 5 nos. (2).
3. Pull the headlight case slightly up, carefully release the tabs- 3 nos. (3).
4. Disconnect the headlight connector, turn signal indicator connector and remove the headlight case (4).

Installation:

1. Installation can be done in the reverse order of removal.

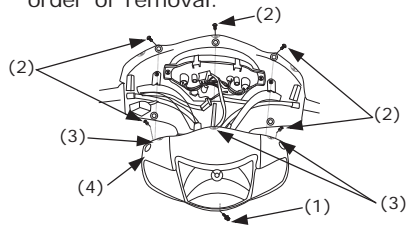

- (1) Screw A (स्कू A) (2) Screws B (स्कू B)  
(3) Tabs (टैब्स) (4) Headlight case (हैडलाइट केस)

## HEADLIGHT AIM VERTICAL ADJUSTMENT

Vertical adjustment can be made by turning the bolt (1) in or out as necessary.

**(Obey local laws and regulations)**

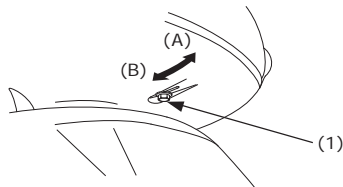

(1) Bolt (बोल्ट)

(A) Up (ऊपर)

(B) Down (नीचे)

## OPERATION PRE-RIDE INSPECTION

For your safety, it is very important to take a few moments before each ride to walk around your scooter and check its condition. If you detect any problem, be sure you take care of it, or have it corrected by your Honda dealer.

### **⚠ WARNING**

Improperly maintaining this scooter or failing to correct a problem before riding can cause a crash in which you can be seriously hurt or killed.

Always perform a pre-ride inspection before every ride and correct all problems.



1. Engine oil level - add engine oil if required (Ref. page 53). Check for leaks.
2. Fuel level - fill fuel tank, when necessary (Ref. page 17). Check for leaks.
3. Front and rear brakes - check operation and if necessary, adjust freeplay (Ref. pages 15-16).
4. Tyres – check condition and pressure (Ref. pages 20–21).
5. Throttle – check for smooth opening and full closing in all steering positions.
6. Lights and horn – check that headlight, tail/brake light, turn signal indicators and horn are functioning properly.
7. Battery electrolyte – check the level and add if necessary (Ref. page 62).

## STARTING THE ENGINE

This scooter has an automatic fuel cock.

Engine can be started using:

- (1) Electric starter
- (2) Kick starter

To protect the catalytic converter in your scooter's exhaust system, avoid extending idling and the use of leaded petrol.

Your scooter's exhaust contains poisonous carbon monoxide gas. High levels of carbon monoxide can collect rapidly in enclosed areas such as a garage. Do not run the engine with garage door closed. Even with the door open run the engine only long enough to move your scooter out of the garage.

### CAUTION

Contact with the spinning rear wheel can hurt.

Set the parking brake when the scooter is on its center stand.

Always follow the proper starting procedure described below.

1. Place the scooter on its center stand.
2. Lock the rear wheel by pressing the Rear brake (Activa Standard) /combi brake (Activa Deluxe) lever (1) and setting the brake lock lever (2).

The electric starter will work when the front brake or Rear brake (Activa Standard) /combi brake (Activa Deluxe) lever is pressed in.

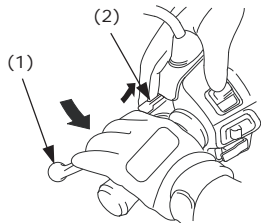

(1) Rear brake (Activa Standard) /combi brake (Activa Deluxe) lever (रियर ब्रेक (एक्टिवा स्टैन्डर्ड) / कॉम्बी ब्रेक (एक्टिवा डीलक्स) लीवर)

(2) Brake lock lever (ब्रेक लॉक लीवर)

3. Turn the ignition switch (3) to ON.

### Incase of Activa (Standard)

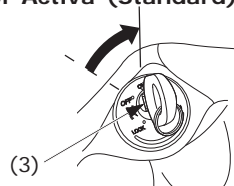

### Incase of Activa (Deluxe)

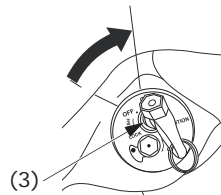

(3) Ignition switch (इग्नीशन स्विच)

4. Pull the choke lever in case of cold engine starting (Use of choke not necessary for warm engine.)

5 (a). Using electric starter

- (i) Press the front brake/rear brake (Activa Standard) / combi brake (Activa Deluxe) lever
- (ii) Press the electric start button

Do not use the electric starter for more than 5 seconds at a time. Release the starter button for approximately 10 seconds before pressing it again.

5 (b). Using kick starter

- (i) Lightly depress the kickstarter until resistance is felt. Then let the kickstarter return to the top of its stroke.
- (ii) With the throttle closed, operate the kick starter. Kick from the top of the stroke through to the bottom with a rapid, continuous motion.
- (iii) Do not allow the kickstarter to snap back freely against the pedal stop as engine case can get damaged.

- (iv) Raise the kickstarter pedal after the kickstarter pedal is returned to the stop.

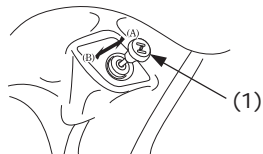

1. Choke knob (चॉक नॉब) (A) Fully ON (पूरा खुला)  
(B) Fully OFF (पूरा बंद)

Operate the kickstarter or starter button for slightly longer than usual without opening the throttle if the scooter has been left standing for a long time or when the fuel tank has been just refilled.

Continue warming up the engine until it runs smoothly. Close the choke lever by pressing it. Responds to the throttle when the choke knob is at Fully OFF (B).

## NOTICE

Extended use of the choke may impair piston and cylinder wall lubrication and damage the engine.

### Cold Engine:

1. Pull the choke knob (1) back all the way to Fully ON (A).
2. Warm up the engine by opening and closing the throttle slightly.

Do not "BLIP" the throttle (open and close rapidly) as the scooter will move forward suddenly, causing possible loss of control.

Do not leave the scooter unattended while the engine is warming up.

### Warm Engine:

1. Do not use the choke
2. Turn throttle 1/8.
3. Start the engine.

## RUNNING-IN

Help assure your scooter's future reliability and performance by paying extra attention to how you ride during the first 500 km.

During this period, avoid full-throttle starts and rapid acceleration.

## RIDING

Review Scooter Safety (Ref. pages 1–8) before you ride.

Make sure flammable material such as dry grass or leaves do not come in contact with the exhaust system when riding, idling or parking your scooter.

1. **Make sure the throttle is closed and the rear brake(Incase of Activa Standard)/combi brake(Incase of Activa Deluxe) is locked** before moving the scooter off the center stand.

The rear wheel must be locked when moving the scooter off the center stand or loss of control may result.

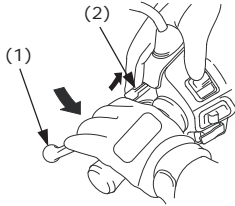

(1) Rear brake (Activa Standard)/combi brake (Activa Deluxe) lever (रियर ब्रेक (एक्टिवा स्टैन्डर्ड)/ कॉम्बी ब्रेक (एक्टिवा डीलक्स) लीवर)

(2) Brake lock lever (ब्रेक लॉक लीवर)

2. **Stand on the left side of the scooter** and push it forward and off the center stand.

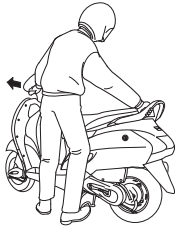

3. **Mount the scooter from the left side** keeping at least one foot on the ground to steady the scooter.



4. **Unlock the rear wheel by releasing the rear brake (Incase of Activa Standard)/combi brake (Incase of Activa Deluxe) lever (1).**

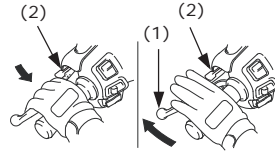

(1) Rear brake (Activa Standard)/combi brake (Activa Deluxe) lever (रियर ब्रेक (एक्टिवा स्टैन्डर्ड)/ कॉम्बी ब्रेक (एक्टिवा डीलक्स) लीवर)

(2) Brake lock lever (ब्रेक लॉक लीवर)

5. **Before starting off**, indicate your direction with the turn signals, and check for safe traffic conditions.

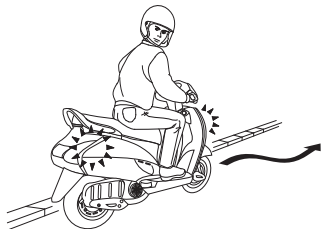

Grasp handlebars firmly with both hands. Never attempt one-handed operation; loss of vehicle control could result.

6. **To accelerate**, open the throttle (3) gradually; the scooter will move forward.

Do not “BLIP” the throttle (open and close rapidly) as the scooter will move forward suddenly, causing possible loss of control.

7. **To decelerate**, close throttle.

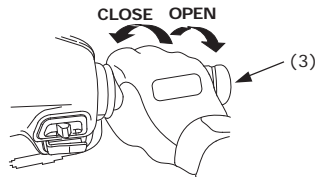

(3) Throttle (थ्रॉटल)

8. **When slowing down the scooter** coordination of the throttle (3), front brake (4) and rear brake (Inc case of Activa Standard)/combi brake (Inc case of Activa Deluxe) (5) is most important.

Both front and rear brake (Inc case of Activa Standard) /combi (Inc case of Activa Deluxe) brakes should be applied together. Independent use of only the front or rear brake reduces stopping performance.

Excessive brake application may cause either wheels to lock, or loss of control on scooter.

**Do not accelerate while applying brakes. This may result severe damage of the related parts**

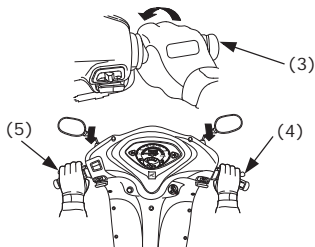

- (3) Throttle (थ्रॉटल) (4) Front brake (फ्रंट ब्रेक)  
 (5) Rear brake (Activa Standard)/ combi brake (Activa Deluxe) (रियर ब्रेक (एक्टिवा स्टैन्डर्ड)/ कॉम्बी ब्रेक (एक्टिवा डीलक्स)).

**9. When approaching a corner or turn,** close the throttle (3) fully, and slow the scooter down by applying both front brake (4) and rear brake (Incise of Activa Standard) /combi (Incise of Activa Deluxe) brake (5) at the same time.

**10. After completing the turn,** open the throttle gradually to accelerate the scooter.

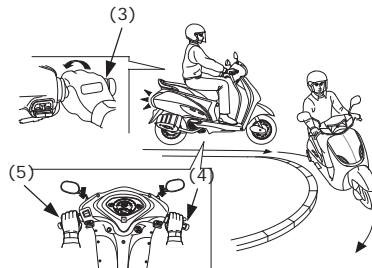

- (3) Throttle (थ्रॉटल)  
 (4) Front brake (फ्रंट ब्रेक)  
 (5) Rear brake (Activa Standard) /combi brake (Activa Deluxe) (रियर ब्रेक (एक्टिवा स्टैन्डर्ड) / कॉम्बी ब्रेक (एक्टिवा डीलक्स)).

**11. When descending a steep grade,** close the throttle (3) fully and apply front brake (4) and rear brake (Incise of Activa Standard) /combi (Incise of Activa Deluxe) brake (5) to slow the scooter.

Avoid continuous use of the brakes, which may result in overheating and reduction of braking efficiency.

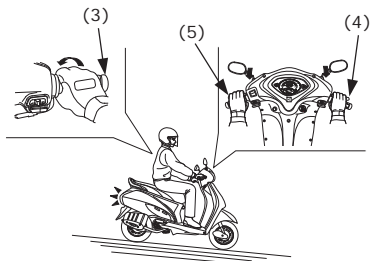

(3) Throttle (थ्रॉटल)

(4) Front brake (फ्रंट ब्रेक)

(5) Rear brake (Activa Standard) /combi brake (Activa Deluxe) (रियर ब्रेक (एक्टिवा स्टैन्डर्ड) / कॉम्बी ब्रेक (एक्टिवा डीलक्स)).

**12. When riding on wet or loose surfaces,** special caution should be taken.

When riding in wet or rainy conditions or on loose surface, the ability to controlled movement and stop will be reduced. For your safety:

- Exercise extreme caution when braking, accelerating or turning.
- Ride at slower speeds and allow for extra stopping distance.
- Keep the scooter as upright as possible.
- Use extreme caution when riding over slippery surfaces such as railroad tracks, iron plates, manhole covers, painted lines, etc.

## PARKING

1. After stopping the scooter turn the ignition switch to the "OFF" position and remove the key. Close the key shutter (Incase of Activa Deluxe).
2. Use the center stand to support the scooter while parked.

Park the scooter on firm, level ground to prevent it from falling over.

If you must park on a slight incline, aim the front of the scooter uphill to reduce the possibility of rolling off the center stand or overturning.



3. Lock the steering to help prevent theft, turn the ignition switch to the "Lock" position and remove the key. (Ref. page 41). Close the key shutter (Incase of Activa Deluxe).

The exhaust pipe and muffler become very hot during operation and remain sufficiently hot to inflict burns if touched even after shutting off the engine.

Make sure flammable material such as dry grass or leaves do not come in contact with the exhaust system when parking your scooter.

### HOW TO USE CENTER STAND



### ANTI-THEFT TIPS

1. Always lock the steering, close the key shutter [Incase of Activa (Deluxe)] and never leave the key in the ignition switch. This sounds simple but people do forget.
  2. Be sure the registration information for your scooter is accurate and current.
  3. Park your scooter in a locked garage, whenever possible.
  4. Use an additional anti-theft device of good quality (without tampering any part of the vehicle).
  5. Put your name, address, phone number and key number in this Owner's Manual and keep it on your scooter at all times.
- Many times stolen scooters are indetified by information in the Owner's Manuals that are still with them.

NAME: \_\_\_\_\_

ADDRESS: \_\_\_\_\_

PHONE NO: \_\_\_\_\_

KEY NO:

### LOCK STEERING

Incase of Activa (Standard)

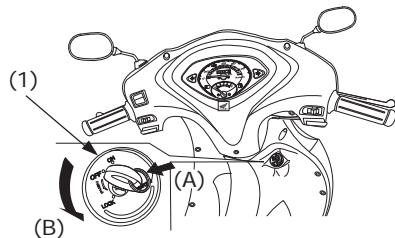

Incase of Activa (Deluxe)

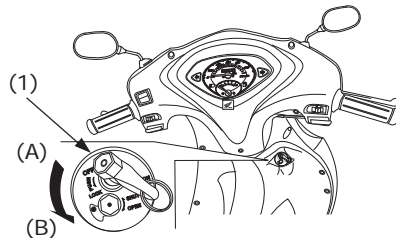

(1) Ignition key (इग्नीशन चाँबी)

(A) Push in (चाँबी को दबायें)

(B) Turn to lock (लॉक करने के लिये धुमायें)

## **MAINTENANCE**

### **THE IMPORTANCE OF MAINTENANCE**

A well-maintained scooter is essential for safe, economical and trouble-free riding. It will also help reduce air pollution.

To help you proper care for your scooter, the following pages include a Maintenance Schedule and a Maintenance Record (Ref. page 47 to 48) for regular scheduled maintenance.

These instructions are based on the assumption that the scooter will be used exclusively for its designed purpose. Sustained high speed operation or operation in unusually wet or dusty conditions will require more frequent service than specified in the Maintenance Schedule. Consult your Honda dealer for recommendations applicable to your individual needs and use.

If your scooter overturns or becomes involved in a crash, be sure your Honda dealer inspects all major parts, even if you are able to make some repairs.

### **WARNING**

Improperly maintaining this scooter or failing to correct a problem before you ride can cause a crash in which you can be seriously hurt or killed.

Always follow the inspection and maintenance recommendations and schedule in this owner's manual.

## **MAINTENANCE SAFETY**

This section includes instructions on some important maintenance tasks. You can perform some of these tasks with the tools provided – if you have basic mechanical skills.

Other tasks that are more difficult and require special tools are best performed by professionals. Wheel removal should normally be handled only by a Honda technician or other qualified mechanic; instructions are included in this manual only to assist in emergency service.

Followings are some of the most important safety precautions. However, we cannot warn you of every conceivable hazard that can arise in performing maintenance. Only you can decide whether or not you should perform a given task.

## **WARNING**

Failure to properly follow maintenance instructions and precautions can cause you to be seriously hurt or killed.

Always follow the procedure and precautions in this owner's manual.

## **SAFETY PRECAUTIONS**

- Make sure the engine is off before you begin any maintenance or repairs. This will help eliminate several potential hazards:
- **Carbon monoxide poisoning from engine exhaust.**  
Be sure there is adequate ventilation whenever you operate the engine.
- **Burns from hot parts.**  
Let the engine and exhaust system cool before touching.
- **Injury from moving parts.**  
Do not run the engine unless instructed to do so.  
Read the instructions before you begin, and make sure you have the tools and skills required.  
To help prevent the scooter from falling over, park it on a firm, level surface, using the center stand to provide support.
- Be sure the rear brake lock is set before running the engine while the scooter is supported by the center stand. This will prevent the rear wheel

from spinning and avoid the possibility of someone being injured from contacting the wheel.

- To reduce the possibility of a fire or explosion be careful when working around petrol or batteries. Use only nonflammable solvent, not petrol, to clean parts. Keep cigarettes, sparks and flames away from the battery and all fuel-related parts.

Remember that your Honda dealer knows your scooter best and is fully equipped to maintain and repair it.

To ensure the best quality and reliability use only new genuine Honda parts or their equivalents for repair and replacement.

## TOOL KIT

The tool kit (1) is located in the center compartment (2).

Some road side repairs, minor adjustments and parts replacement can be performed with the tools contained in the kit.

- Spark plug wrench  
(for opening spark plug)
- 6 x 10 mm open end spanner  
(for opening 6 mm and 10 mm thread dia bolts)
- Standard/Phillips screwdriver  
(for opening all screws)
- Screwdriver handle
- 4 x 8 mm open end spanner  
(for opening 4 mm and 8 mm thread dia bolts)
- Tool bag  
(for carrying all above tools)

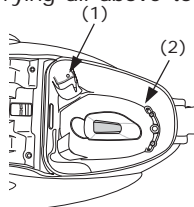

(1) Tool kit (टूल किट)

(2) Center compartment (सैंटर कम्पार्टमेंट)

## MAINTENANCE SCHEDULE

Perform the pre-ride Inspection (Ref. page 32) at each scheduled maintenance period.

I:INSPECT, CLEAN, ADJUST, LUBRICATE OR REPLACE IF NECESSARY

C:CLEAN R:REPLACE A:ADJUST L:LUBRICATE.

The following items require some mechanical knowledge. Certain item (particularly those marked \* and \*\*) may require more technical information and tools. Consult your Honda dealer.

- \* Should be serviced by your Honda dealer, unless the owner has the proper tools and service data and is mechanically qualified. Refer to the Official Honda Shop Manual.
- \*\* In the interest of safety, we recommend these items be serviced only by your Honda dealer.

Honda recommends that the customer should road test your scooter after each periodic maintenance is carried out.

- NOTES: (1) At higher odometer reading, repeat at the frequency interval established here.
- (2) Service more frequently when riding in unusually wet or dusty areas.
  - (3) Service more frequently when riding in rain or at full throttle.
  - (4) Replace every 2 years. Replacement requires mechanical skill.

FREQUENCY  ITEM		WHICHEVER COMES FIRST ↓	→ SERVICE DAYS	ODOMETER READING [NOTE (1)]						
				1st	2nd	3rd	4th	PAID SERVICE (Subsequent days/Kms applicable from last service)		
		NOTE	KMS	30	120	210	300	90	180	REMARK
				750	3000	6000	9000	3000	6000	
*	FUEL LINE					I			I	
*	THROTTLE OPERATION				I	I	I	I		
*	CARBURETOR CHOKE				I	I	I	I		
	AIR CLEANER	(NOTE 2)	Do not open the air cleaner element until 15000 kms. unless there is any driveability problem.							Replace every 15000 kms
	CRANKCASE BREATHER	(NOTE 3)			C	C	C	C		
	SPARK PLUG			I	I	I	R	I		Replace every 9000 kms
*	VALVE CLEARANCE					I			I	
	ENGINE OIL	(NOTE 2)		R	I	R	I	Top up every 3000 kms. Replace every 6000 kms.		
*	ENGINE OIL STRAINER SCREEN			C		C			C	
*	ENGINE IDLE SPEED			I	I	I	I	I		
	SECONDARY AIR FILTER	(NOTE 2)		C	C	C	C	C		Replace every 12000 kms
*	DRIVE BELT CASE				C	C	C	C		
*	DRIVE BELT						I			Inspect every 9000 kms Replace every 24000 kms
*	FINAL DRIVE OIL	(NOTE 4)								Inspect every 12000 kms Replace every 24000 kms
	BATTERY				I	I	I	I		

The scooter must be serviced at every 3000 kms or within 3 months whichever is earlier from the date of previous service.

FREQUENCY  ITEM		WHICHEVER →		ODOMETER READING [NOTE (1)]						
		COMES FIRST ↓	SERVICE DAYS	1st	2nd	3rd	4th	PAID SERVICE		
				30	120	210	300	(Subsequent days /Kms applicable from last service)		
			NOTE	750	3000	6000	9000	3000	6000	REMARK
	BRAKE SHOES WEAR					I			I	
*	BRAKE LOCK OPERATION			I	I	I	I	I		
	BRAKE LIGHT SWITCH			I	I	I	I	I		
	STARTER SWITCH			I	I	I	I	I		
*	HEADLIGHT/INDICATOR SWITCH			I	I	I	I	I		
**	CLUTCH SHOES WEAR				I	I	I	I		
*	HEADLIGHT ADJUSTMENT					I			I	
*	SUSPENSION					I			I	
*	NUTS, BOLTS, FASTENERS			I	I	I	I	I		
**	WHEELS/TYRES			I	I	I	I	I		
**	STEERING MOVEMENT			I	I	I	I	I		
	WASHING AND CLEANING			C	C	C	C	C		
	TEST DRIVE			I	I	I	I	I		
	CLUTCH/BRAKE/ THROTTLE FREE PLAY			I	I	I	I	I		

The scooter must be serviced at every 3000 kms or within 3 months whichever is earlier from the date of previous service.



## SERIAL NUMBER

The frame and engine serial numbers are required when registering your scooter. They may also be required by your dealer when ordering replacement parts.

Record the numbers here for your reference.

FRAME NO. \_\_\_\_\_

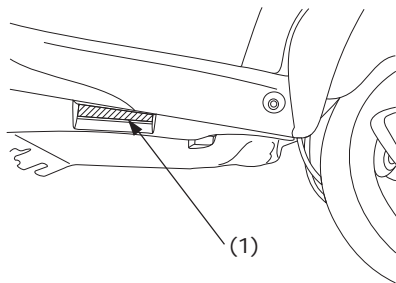

(1) Frame number (फ्रेम नम्बर)

The frame number (1) is stamped on the right side of the frame body.

The engine number (2) is stamped on the left side of the crankcase.

ENGINE NO. \_\_\_\_\_

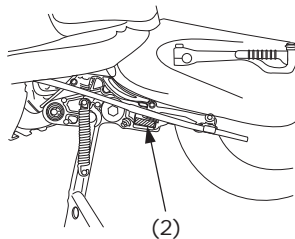

(2) Engine number (इंजन नम्बर)

## COLOUR CODE

The colour table is attached below.

It is useful during ordering the replacement parts.

S.No.	Color	Color code
1.	Black	NH1
2.	Geny Gray Metallic	NHA04
3.	Force Silver Metallic	NH411
4.	Pearl Sunbeam White	NHA66
5.	Wild Purple Metallic	RP175
6.	Candy Lucid Red	R264

The above colour code table helps in providing the correct colour part as per your vehicle colour.

## AIR CLEANER

Refer to the Safety Precautions on page 44. The air cleaner element should be replaced at regular intervals (Ref. page 47). Replace more frequently when riding in unusually wet or dusty areas.

1. Lift up the body cover (Ref. page 29).
2. Remove the air cleaner cover (1) by removing the screws A (2) - 6 nos.
3. Remove the Air cleaner (4) by removing the screw B (3) - 1 no.

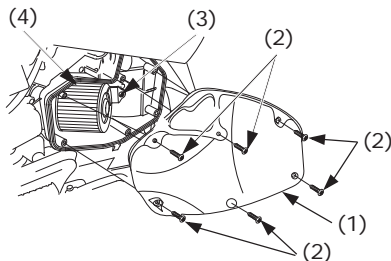

- (1) Air cleaner maintenance cover (एयर क्लीनर मैनटेनेंस कवर)  
(2) Screws A (स्कूज A) (3) Screw B (स्कूज B)  
(4) Air cleaner (एयर क्लीनर)

4. Viscous type air filters should be replaced regularly. Do not reuse it by cleaning with solvent to remove dust.

The special oil will be lost and filter becomes dry. As the base filter paper is coarse, it cannot block fine dust when it becomes dry.

5. Replace the air cleaner element if it is excessively dirty, torn or damage. Use the Honda genuine air cleaner element or an equivalent air cleaner element specified for your model. Using the wrong Honda air cleaner element or a non-Honda air cleaner element which is not of equivalent quality may cause premature engine wear or performance problems.
6. Install the removed parts in the reverse order of removal.

## CAUTION

Do not use air, oil, water for cleaning of air cleaner element. Replacement should be done at regular intervals.

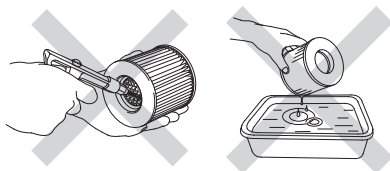

## SECONDARY AIR SUPPLY SYSTEM

Refer to the Safety Precautions on page 44.

### Secondary Air filter cleaning

The air filter should be serviced at regular intervals (Ref. page 47). Service more frequently when riding in unusually wet or dusty areas.

1. Lift up the body cover (page 29).
2. Remove the air filter housing cover (1) by removing the screw (2).

3. Remove the air filter (3).
4. Wash the air filter in clean, nonflammable or high flash point solvent and let it dry thoroughly.

Never use gasoline or low flash point solvents for cleaning the secondary air filter. A fire or explosion could result.

5. Soak the air-cleaner in engine oil (SAE 20W-40) until saturated, then squeeze out the excess oil.
6. Install the removed parts in the reverse order of removal.

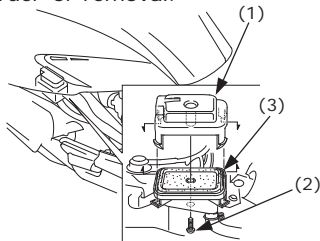

- (1) Air filter housing cover (एयर फिल्टर हाउजिंग कवर)  
 (2) Screw (स्कू) (3) Air filter (एयर फिल्टर)

## CRANKCASE BREATHER

Refer to the Safety Precautions on Page 44.

1. Open the clamp (1) and remove crankcase breather tube (2) from the air cleaner and drain deposits into a suitable container .
2. Periodically clean up breather oil from breather tube.
3. Reinstall the crankcase breather tube.

Service more frequently when riding in rain, at full throttle, or after the scooter is washed or overturned. Service if the deposit level can be seen in the transparent section of the drain tube.

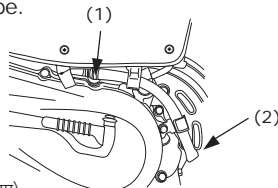

- (1) Clamp (कलैम्प)  
 (2) Crankcase breather tube (क्रैंककेस ब्रीदर ट्यूब)

## ENGINE OIL

Refer to the Safety Precautions on page 44.

### Engine Oil

Good engine oil has many desirable qualities. Use only high detergent, quality motor oil certified on the container to meet or exceed requirements for API Service Classification SJ.

### Viscosity:

Viscosity grade of engine oil should be based on average atmospheric temperature in your riding area. The following provides a guide to the selection of the proper grade or viscosity of oil to be used at various atmospheric temperatures.

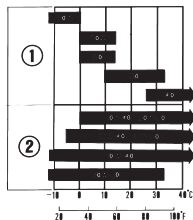

(1) Single grade (सिंगल ग्रेड)

(2) Multi grade (मल्टी ग्रेड)

## ENGINE OIL

Engine oil quality is the chief factor affecting engine service life. Change the engine oil as specified in the maintenance schedule (Ref. page 47).

When running in very dusty conditions, oil changes should be performed more frequently than specified in the maintenance schedule.

Please dispose of used engine oil in a manner that is compatible with the environment. We suggest you take it in a sealed container to your local recycling center or service station for reclamation. Do not throw it in the trash or pour it on the ground or down a drain.

Used engine oil may cause skin cancer if repeatedly left in contact with the skin for prolonged periods. Although this is unlikely unless you handle used oil on a daily basis, it is still advisable to thoroughly wash your hands with soap and water as soon as possible after handling used oil.

If a torque wrench is not used for this installation, see your Honda dealer as soon as possible to verify proper assembly.

Change the engine oil from the engine at normal operating temperature and the scooter on its center stand to assure complete and rapid draining.

1. Start the engine and let it idle for 3-5 minutes.
2. Stop the engine. Turn the ignition off and to be on safer side remove the ignition key from ignition switch.
3. Place an oil drain pan under the crankcase. Remove the oil filler cap/dipstick, oil drain bolt (1) and sealing washer (2).
4. After the engine oil has been drained out hold the scooter upright for 10-15 seconds to assure complete draining.
5. Operate the kickstarter several times to aid in complete draining of the remaining oil.
6. Check that the sealing washer (2) on the drain bolt is in good condition and install the bolt. Replace the sealing washer every

other time the oil is changed, or each time if necessary.

Oil Drain Bolt Torque:

24 N.m (2.5 kgf.m, 18 lbf.ft)

7. Fill the crankcase with recommended grade oil;  
0.7L (0.7 US qt, 0.6 Imp qt)
8. Reinstall the oil filler cap/dipstick.
9. Start the engine and let it idle for 3-5 minutes.
10. Stop the engine and wait 2-3 minutes. Check that the oil level is at the upper level mark on the dipstick with the scooter upright on firm, level ground.  
Make sure there are no oil leaks.

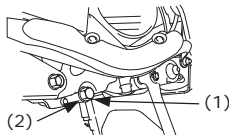

(1) Oil drain bolt (ऑयल ड्रेन बोल्ट)

(2) Sealing washer (सीलिंग वाशर)

## ENGINE OIL STRAINER SCREEN

1. To drain the oil, remove the oil filler cap/ dipstick, oil drain plug and sealing washer (Ref. page 54).
2. Remove the oil strainer screen cap (1), spring (2) and oil strainer screen (3).
3. Clean the oil strainer screen.
4. Check that the oil strainer screen, sealing rubber and O-ring (4) are in good condition.

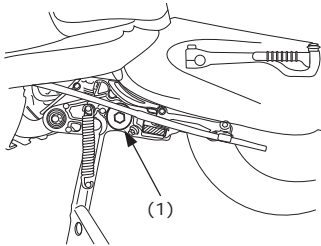

(1) Oil strainer screen cap (ऑयल स्ट्रेनर स्क्रीन कैप)

5. Install the oil strainer screen spring, O-ring and oil strainer screen cap.

Oil Strainer Screen Cap Torque:

20 N.m (2.0 kgf.m, 14 lbf.ft)

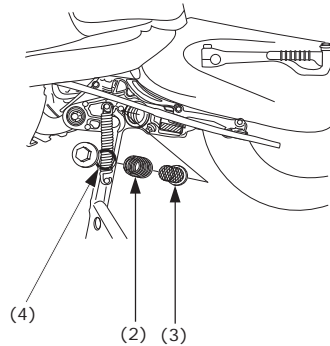

(2) Spring (स्प्रिंग)

(3) Oil strainer screen (ऑयल स्ट्रेनर स्क्रीन)

(4) O-ring (O-रिंग)

6. Fill the crankcase with the recommended grade oil;  
0.7L (0.7 US qt, 0.6 Imp qt)
7. Reinstall the oil filler cap/dipstick.
8. Start the engine and let it idle for 3-5 minutes.
9. Stop the engine and wait for 2-3 minutes. Check that the oil level is at the upper level mark on the oil filler cap/dipstick with the scooter upright on firm, level ground. Make sure that there are no oil leaks.

## SPARK PLUG

Refer to the Safety Precautions on page 44.  
Recommended plugs:

Standard:

NGK CPR7EA-9

## NOTICE

Never use a spark plug with an improper heat range. Severe engine damage could result.

1. Remove the engine front cover.
2. Disconnect the spark plug cap (2) from the spark plug (1).
3. Clean any dirt from around the spark plug base.
4. Remove the spark plug (1) using the spark plug wrench furnished in the tool kit.

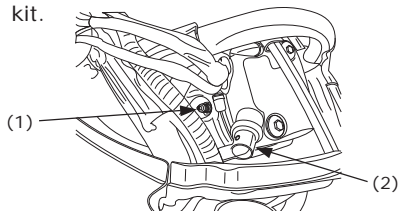

- (1) Spark plug (स्पाक प्लग)  
(2) Spark plug cap (स्पाक प्लग कैप)



5. Inspect the electrodes and center porcelain for deposits, erosion or carbon fouling. If the erosion or deposit is heavy, replace the plug. Clean a carbon or wetfouled plug with a plug cleaner, otherwise use a wire brush.
6. Check the spark plug gap (3) using a wire gauge. If adjustment is necessary, bend the side electrode (4) carefully. The gap should be:  
0.80–0.90 mm (0.031–0.035 in)

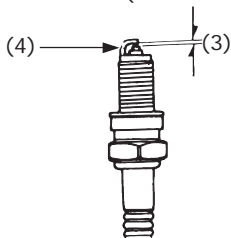

(3) Spark plug Gap (स्पार्क प्लग गैप)

(4) Side Elecrode (साइड इलैक्ट्रोड)

7. With the plug washer attached thread the spark plug in by hand prevent cross-threading.
8. Tighten the spark plug:
  - If the old plug is good  
1/8 turn after it seats.
  - If installing a new plug, tighten it twice to prevent loosening:
    - a) First tighten the plug:  
NGK: 3/4 turn after it seats.
    - b) Then loosen the plug.
    - c) Next, tighten the plug again:  
1/8 turn after it seats.

#### NOTICE

Improperly tightened of spark plug may damage the engine.

9. Reinstall the spark plug cap.

## ENGINE IDLE RPM

Refer to the Safety Precautions on page 44. The engine must be at normal operating temperature for accurate idle speed adjustment. Ten minutes of stop-and-go riding is sufficient.

1. Warm up the engine, and place the scooter on its center stand.
2. Lift up the body cover (Ref. page 29).
3. Connect a tachometer to the engine.
4. Adjust idle speed with the throttle stop screw (1).

Idle speed (In neutral) :  
 $1,700 \pm 100 \text{ min}^{-1} (\text{rpm})$

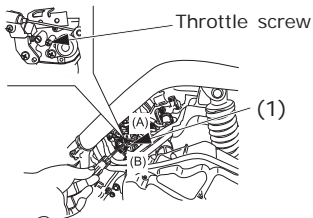

(1) Throttle stop screw (थ्रॉटल स्टॉप स्क्रू)

(A) Increase (बढ़ाना) (B) Decrease (घटाना)

## WHEEL REMOVAL

Refer to the Safety Precautions on Page 44.

### Front Wheel Removal

1. Place the scooter on its center stand.
2. Raise the front wheel off the ground by pressing from rear side.
3. Remove the speedometer cable (1) by pushing the tab (2).

### Incase of Activa (Standard)

4. Remove the front brake adjusting nut (3) and remove the front brake cable (4) from the brake arm (5).

### Incase of Activa (Deluxe)

Remove the front brake both adjusting nuts (3) and remove the front brake both cables (4) from the brake arm (5).

5. Remove the front axle nut (6).
6. Remove the front axle (7), collar (8) and the wheel.

### Incase of Activa (Standard)

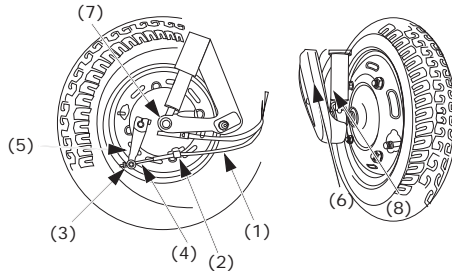

### Incase of Activa (Deluxe)

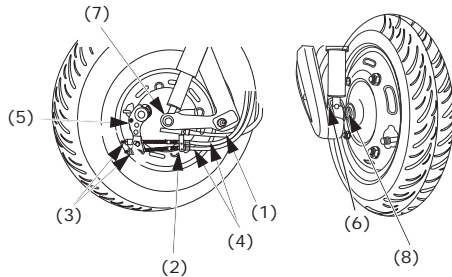

- (1) Speedometer cable (स्पीडोमीटर केबल)
- (2) Tab (टैब)
- (3) Rear brake (Activa Standard) /combi brake (Activa Deluxe) adjusting nut cable (रियर ब्रेक (एक्टिवा स्टैन्डर्ड) / कॉम्बी ब्रेक (एक्टिवा डीलक्स) एडजस्टिंग नट केबल)
- (4) Rear brake (Activa Standard) /combi brake (Activa Deluxe) (रियर ब्रेक (एक्टिवा स्टैन्डर्ड) / कॉम्बी ब्रेक (एक्टिवा डीलक्स))
- (5) Brake arm (ब्रेक आर्मी)
- (6) Front axle nut (फ्रंट एक्सल नट)
- (7) Front axle shaft (फ्रंट एक्सल शाफ्ट)
- (8) Collar (कॉलर)

## Front Wheel Installation

1. Position the wheel between the fork legs and insert the front axle from the left side, through the left fork leg, wheel hub, collar and right fork leg. Make sure that the tang (9) on the left front fork leg is located in the slot (10) in the brake panel.
2. Tighten the front axle nut to the specified torque.  
59 N.m (6.0 kgf.m, 43 lb f. ft)

## Incase of Activa (Standard)

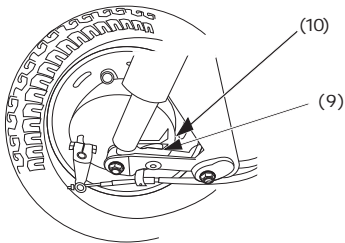

## Incase of Activa (Deluxe)

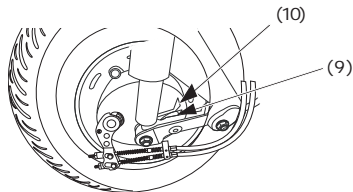

(9) Tang (टैंग)

(10) Slot (स्लॉट)

3. Adjust the brake (page 14 - 16).
4. After installing the wheel, apply the brake several times and then check if the wheel rotates freely. Recheck the wheel if the brake drags or if the wheel does not rotate freely.  
If a torque wrench was not used for installation, see your Honda dealer as soon as possible to verify proper assembly. Improper assembly may lead to loss of braking capacity.

## Rear Wheel Removal

1. Place the scooter on its center stand.
2. Remove the rear wheel nut by applying rear brake
3. Remove the rear wheel.

## BRAKE SHOE WEAR

Refer to the Safety Precautions on page 44. The front and rear brakes are equipped with brake wear indicators.

When the brake is applied, an arrow mark (1) attached to the brake arm (2) moves toward a reference mark (3) on the brake panel (4). If the arrow aligns with the reference mark on full application of the brake, the brake shoes must be replaced.

See your Honda dealer for this service.

When the brake service is necessary, see your Honda dealer. Use only genuine Honda parts or its equivalent.

## Incase of Activa (Standard)

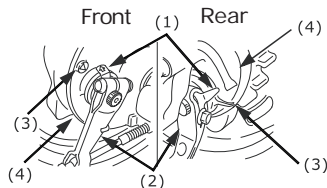

## Incase of Activa (Deluxe)

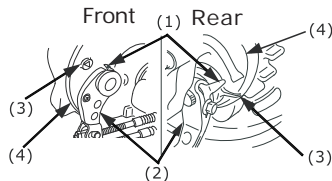

- (1) Arrow mark (ऐरो मार्क)
- (2) Brake arm (ब्रेक आर्म्)
- (3) Reference mark (रेफरेन्स मार्क)
- (4) Brake panel (ब्रेक पैनल)

## BATTERY

Refer to the Safety Precautions on Page 44.

If the scooter is operated with insufficient battery electrolyte, sulfation and battery plate damage will occur.

If rapid loss of electrolyte is experienced, or if your battery seems to be weak, causing slow starting or other electrical problems, see your Honda dealer.

### **WARNING**

The battery contains sulfuric acid (electrolyte) which is highly corrosive and poisonous.

Getting electrolyte in your eyes or on your skin can cause serious burns.

Wear protective clothing and eye protection when working near the battery.

**KEEP CHILDREN AWAY FROM THE BATTERY**

## Emergency Procedures

**Eyes**—Flush with water from a cup or other container for at least fifteen minutes (Water under pressure can damage the eye). Immediately call a physician.

**Skin** – Remove contaminated clothing. Flush the skin with large quantities of water. Call a physician immediately.

**Swallowing** – Drink water or milk. Call a physician immediately.

## BATTERY ELECTROLYTE

The battery (1) is behind the front center cover.

1. Turn the ignition switch OFF.
2. Remove the front center cover (Ref. page 30).
3. Check the electrolyte level with the scooter in an upright position on level ground. The electrolyte level must be maintained between the UPPER (2) and LOWER (3) level marks on the side of the battery.

4. If the electrolyte level is low, disconnect the battery breather tube (4) from the battery outlet.
5. Remove the battery (Ref. page 62).
6. Remove the battery filler caps (5).
7. Carefully add distilled water to UPPER LEVEL mark, using a small plastic funnel.

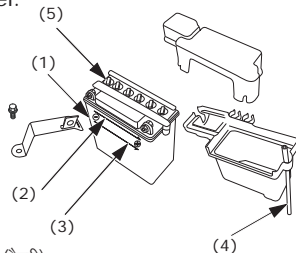

- (1) Battery (बैटरी)
- (2) UPPER level mark (ऊपरी स्तर चिन्ह)
- (3) LOWER level mark (निचला स्तर चिन्ह)
- (4) Battery breather tube (बैटरी ब्रीदर ट्यूब)
- (5) Filter caps (फिल्टर कैप)

## NOTICE

Battery fluid is highly corrosive and can damage metal or painted surfaces. Use care when adding distilled water.

Filling the battery above the UPPER LEVEL line may cause the electrolyte to overflow, resulting in corrosion to engine or frame parts. Immediately wash off any spilled electrolyte.

Running the scooter without properly charged battery may damage electrical parts.

When checking battery fluid level, or adding distilled water, make sure the breather tube is connected to the battery breather outlet. The battery breather tube must be routed as shown on the label.

Do not bend or twist the breather tube.

A bent or kinked breather tube may pressurize the battery and damage its case.

## BATTERY REMOVAL

1. Remove the front center cover (Ref. page 30).
2. Remove the battery holder (1) by removing the bolt (2).

3. Remove the battery upper cover (3).
4. Disconnect battery breather tube (4).
5. Disconnect the negative (-) terminal lead (5) from the battery first, then disconnect the positive (+) terminal lead (6).
6. Remove the battery (7).

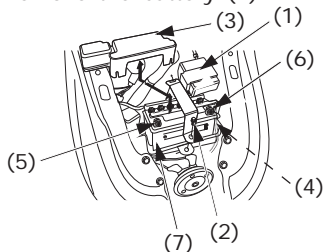

- (1) Battery holder (बैटरी होल्डर)
- (2) Bolt (बोल्ट)
- (3) Battery upper cover (बैटरी ऊपरी कवर)
- (4) Battery breather tube (बैटरी ब्रीदर ट्यूब)
- (5) Negative (-) terminal lead (नैगेटिव (-) टर्मिनल लीड)
- (6) Positive (+) terminal lead (पॉजिटिव (+) टर्मिनल लीड)
- (7) Battery (बैटरी)

## FUSE REPLACEMENT

Refer to the Safety Precautions on page 44.

When frequent fuse failure occurs, it usually indicates a short circuit or an overload in the electrical system. See your Honda dealer for repair.

### NOTICE

Never use a fuse with a different rating from that specified. Serious damage to the electrical system or a fire may result, causing a dangerous loss of lights or engine power.

Blown fuse (ब्लोन फ्यूज)

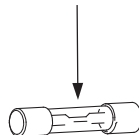



## Fuse Holder:

The fuse holder is located near the battery.

The specified fuse is: 10A

1. Turn the ignition switch OFF before checking or replacing the fuses to prevent an accidental short-circuit.
2. Remove the front center cover (Ref. page 30).
3. Open the fuse holder (1) and lift out the fuse (3) from the clips (4).
4. Slide the old fuse out of the clips and discard it.
5. Slide the clips onto the ends of the new fuse, push them back into the fuse holder, and close the fuse holder. The spare fuse (2) is located in the fuse holder.

Do not pry the clips open to get a fuse out; you could bend them and cause poor contact with the new fuse. A loose fuse could cause damage to the electrical system and even cause a fire.

6. After replacing the fuse be sure to return the fuseholder to its original location.

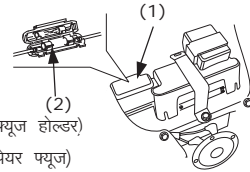

(1) Fuse holder (फ्यूज होल्डर)

(2) Spare fuse (स्पेयर फ्यूज)

7. Install the fuse holder and front center cover.

If you do not have a replacement fuse with the proper rating for the circuit, install one with a lower rating.

## Removal

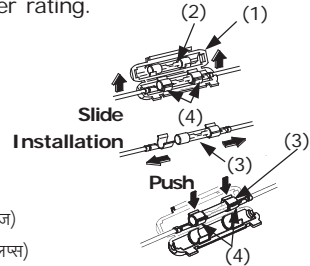

(3) Fuse (फ्यूज)

(4) Clips (क्लिप्स)

## NOTICE

Replacing a fuse with one that has a higher rating greatly increases the chance of damage to the electrical system.

If the replacement fuse of the same rating burns out in a short time, there is probably a serious electrical problem on your scooter. Leave the blown fuse in that circuit and have your scooter checked by your Honda dealer.

## BULB REPLACEMENT

Refer to the Safety Precautions on page 44.

The light bulb becomes very hot while the light is ON, and remain hot for a while after it is turned OFF. Be sure to let it cool down before servicing.

- Be sure to turn the ignition switch OFF when replacing the bulb.
- Do not use bulbs other than those specified.
- After installing a new bulb, check that the light operates properly.

## HEADLIGHT BULB

1. Remove the headlight case (Ref. page 31).
2. Remove the dust cover (1).
3. Remove the bulb (4) while pressing down the locking pin (3).
4. Install a new bulb in the reverse order of removal.
- Install the dust cover with its "TOP" mark (5) facing up.

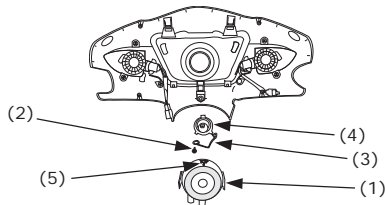

- (1) Dust cover (डस्ट कवर)
- (2) Screw (स्कू)
- (3) Locking Pin (लॉकिंग पिन)
- (4) Headlight bulb (हेडलाईट बल्ब)
- (5) "Top" mark (टॉप मार्क)

## Stop/Tail Light Bulb

1. Insert hand from bodycover rear side, above rear fender area and remove tail signal bulb holder (1) by turning counterclockwise.
2. Remove the bulb (2) from bulb holder by pressing in and turning counterclockwise.
3. Install a new bulb in the reverse order of removal.

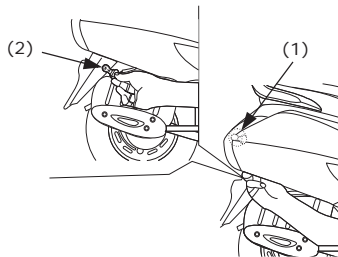

- (1) Taillight bulb holder (टेललाईट बल्ब होल्डर)  
(2) Taillight Bulb (टेललाईट बल्ब)

## Front Turn Signal Bulb

1. Remove the front center cover (Ref. page 30).
2. Remove the turn signal bulb holder (1) by turning counterclockwise.
3. Remove the bulb (2) from bulb holder by pressing in and turning counterclockwise.
4. Install a new bulb in the reverse order of removal.

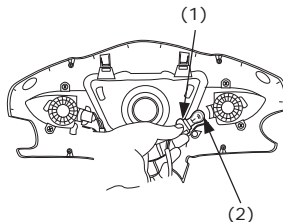

- (1) Turn signal bulb holder (टर्न सिग्नल बल्ब होल्डर)  
(2) Bulb (बल्ब)

## Rear Turn Signal Bulb

1. Insert hand from bodycover rear side, above rear fender area and remove turn signal bulb holder (1) by turning counterclockwise.
2. Remove the bulb (2) from bulb holder by pressing in and turning counter clockwise.
3. Install a new bulb in the reverse order of removal.

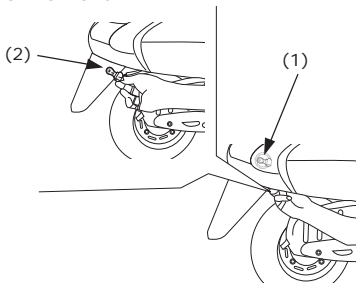

- (1) Turn signal bulb holder (टर्न सिग्नल बल्ब होल्डर)  
(2) Bulb (बल्ब)

## CLEANING

Clean your scooter regularly to protect the surface finishes and inspect for damage, wear, and oil leakage.

Avoid cleaning products that are not specifically designed for scooter or automobile surfaces.

They may contain harsh detergents or chemical solvents that could damage the metal, paint, and plastic on your scooter.

If your scooter is still warm from recent operation, give the engine and exhaust system time to cool off.

We recommend avoiding the use of high pressure water spray (typical in coinoperated car washes).

### NOTICE

High pressure water (or air) can damage certain parts of the scooters.

## Washing the scooter

1. Rinse the scooter thoroughly with cool water to remove loose dirt.
2. Clean the scooter with a sponge or soft cloth using cool water.

Avoid directing water to muffler outlets and electrical parts.

3. Clean the plastic parts using a cloth or sponge dampened with a solution of mild detergent and water. Rub the soiled area gently rinsing it frequently with fresh water.

Take care to keep chemical solvents off the scooter. They will damage the plastic and painted surfaces.

The inside of the headlight lens, tail lamp, indicators etc. may be clouded immediately after washing the scooter. Moisture condensation inside the headlight lens will disappear gradually by lighting the headlight in high beam. Run the engine while keeping the headlight on.

4. After cleaning, rinse the scooter thoroughly with plenty of clean water. strong detergent residue can corrode alloy parts.
5. Dry the scooter start the engine, and let it run for several minutes.

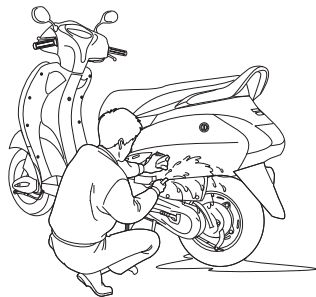

6. Test the brakes before riding the scooter. Several applications may be necessary to restore normal braking performance.

Braking efficiency may be temporarily impaired immediately after washing the scooter.

Anticipate longer stopping distance to avoid a possible accident.

### TEST BRAKES

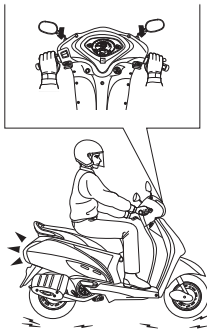

### Finishing Touches

After washing your scooter, consider using a commercially-available spray cleaner/polish or quality liquid or paste wax to finish the job. Use only a non-abrasive polish or wax made specifically for motorcycles or automobiles. Apply the polish or wax according to the instructions on the container.

### Removing Road Salt

The salt contained in the road surface freezing prevention medicine which a road was sprayed with in winter, and the seawater becomes the cause which rust occurs in.

Wash your scooter by the following point after it runs through such a place.

1. Clean the scooter using cool water (Ref. page 68-70).

Do not use warm water.  
This worsens the effect of the salt.

2. Dry the scooter and the surface of the metal is protected with the wax.

## STORAGE GUIDE

Extended storage, such as for winter, requires that you take certain steps to reduce the effects of deterioration from non-use of the scooter. In addition necessary repairs should be made BEFORE storing the scooter, otherwise, these repairs may be forgotten by the time the scooter is removed from storage.

### STORAGE

1. Change the engine oil.
2. Empty the fuel tank into an approved petrol container using a commercially available hand siphon or an equivalent method. Spray the inside of the tank with an aerosol rust-inhibiting oil.

Reinstall the fuel fill cap on the tank.

If storage will last more than one month carburetor draining is very important, to assure proper performance after storage.

## WARNING

Petrol is highly flammable and explosive. You can be burned or seriously injured while handling the same.

- Stop the engine and keep heat, sparks, and flame away.
  - Refuel only outdoors.
  - Wipe up spills immediately.
3. To prevent rusting in the cylinder, perform the following :
    - Remove the spark plug cap from the spark plug. Using tape or string, secure the cap to any convenient plastic body part so that it is positioned away from the spark plug.
    - Remove the spark plug from the engine and store it in a safe place. Do not connect the spark plug to the spark plug cap.

- Pour a tablespoon (15-20 cm<sup>3</sup>) of clean engine oil into the cylinder and cover the spark plug hole with a piece of cloth.
  - Crank the engine several times to distribute the oil.
  - Reinstall the spark plug and spark plug cap.
4. Remove the battery. Store in an area protected from freezing temperatures and direct sunlight. Check the electrolyte level and slow charge the battery once a month.
  5. Wash and dry the scooter. Wax all painted surfaces. Coat chrome with rust inhibiting oil.
  6. Inflate the tyres to their recommended pressures. Place the scooter on blocks to raise both tyres off the ground.
  7. Cover the scooter (don't use plastic or other coated materials) and store in an unheated area, free of dampness with a minimum of daily temperature variation. Do not store the scooter in direct sunlight.

## **REMOVAL FROM STORAGE**

1. Uncover and clean the scooter.  
Change the engine oil if more than 4 months have passed since the start of storage.
2. Check the battery electrolyte level and charge the battery as required. Install the battery.
3. Drain any excess aerosol rust-inhibiting oil from the fuel tank. Fill the fuel tank with fresh petrol.
4. Perform all Pre-ride Inspection checks (Ref. page 32)

Test ride the scooter at low speeds in a safe riding area away from traffic.



## **SPECIFICATIONS**

### **DIMENSIONS**

Overall length	1761 mm (69.3 in)
Overall width	710 mm (28.0 in)
Overall height	1147 mm (45.2 in)
Wheelbase	1238 mm (48.7 in)

### **WEIGHT**

Dry weight	107 kg (236 lbs)
------------	------------------

### **CAPACITIES**

Engine Oil	After draining	0.7 L (0.7 US qt, 0.6 Imp qt)
	After disassembly	0.8 L (0.8 US qt, 0.7 Imp qt)
Fuel tank		5.3 L (1.4 US gal, 1.17 Imp gal)
Transmission oil	After draining	0.10 L (0.11 US qt, 0.09 Imp qt)
	After disassembly	0.12 L (0.13 US qt, 0.11 Imp qt)
Passenger capacity		
Maximum weight capacity		170 kg (375 lbs)

## ENGINE

Bore and stroke	50.0 x 55.0 mm (1.97 x 2.19 in)
Compression ratio	9.5 : 1
Displacement	108.9 cm <sup>3</sup> (6.65 cu-in)
Spark Plug	
Standard	NGK CPR7EA-9
Spark plug gap	0.80 - 0.90 mm (0.031 - 0.035 in)
Idle speed	1,700 ± 100 min <sup>-1</sup> (rpm)

## CHASSIS AND SUSPENSION

Caster	27°30'
Trail	92 mm (3.5 in)

### Incase of Activa (Standard)

Front	90/100-10 53J
Rear	90/100-10 53J

### Incase of Activa (Deluxe)

Front	90/100-10 53J - Zapper
Rear	90/100-10 53J - Zapper

## POWER TRANSMISSION

Primary reduction	V-Belt
Final reduction	9.423

## ELECTRICAL

Battery	12V - 5Ah
Generator	0.110kW/5,000 min <sup>-1</sup> (rpm)

## LIGHT

Headlight		12V-35/35W
Stop/tail light		12V-5/21W
Turn signal light	Front	12V-21W
	Rear	12V-21W
Speedometer light		12V-1.7Wx2
Turn signal indicator		12V-3W
High beam indicator		12V-1.7W

## FUSE

Main fuse	10A
-----------	-----

## CATALYTIC CONVERTER

This Scooter is equipped with a catalytic converter.

The catalytic converter contains precious metals that serve as catalysts, promoting chemical reactions to convert the exhaust gasses without affecting the metals.

The catalytic converter acts on HC, CO, and NOx. A replacement unit must be an original Honda part or its equivalent.

The catalytic converter must operate at a high temperature for the chemical reactions to take place. It can set on fire any combustible materials that come near it. Mark your scooter away from high grasses, dry leaves, or other flammables.

A defective catalytic converter contributes to air pollution, and can impair your engine's performance. Follow these guidelines to protect your motorcycle's catalytic converter.

- Always use unleaded petrol. Even a small amount of leaded petrol can contaminate the catalyst metals, making the catalytic converter ineffective.
- Keep the engine tuned-up.
- Have your scooter diagnosed and replaced if it is misfiring, backfiring stalling or otherwise not running properly.

